



BRUHAT BENGALURU MAHANAGARA PALIKE

No. DCF/PR. 330 /2023-24/

Office of
The Deputy Conservator of Forests,
Bruhat Bengaluru Mahanagara Palike,
N R Square, Annex Building - 3,
Bengaluru, Date: 16.06.2023

PUBLIC NOTICE

This is to bring to the notice of the Citizens of Bengaluru that the Deputy Chief Engineer, Reach 6, UG, BMRCL, has submitted an application to the undersigned for removal of tree standing at the Rashtriya Military School Metro Station area for BMRCL Reach 6, UG Works, Bengaluru. The details are given below:

Name of the project	Construction of Elevated Rashtriya Military School Metro Station in Reach 6, Under Ground Line		
Name of the Agency	Bangalore Metro Rail Corporation Limited (BMRCL), Bengaluru		
Purpose for removal of trees	The tree is standing in the area of Rashtriya Military School Metro Station Project Area and coming within the station ancillary building, Reach 6, UG Works, Bengaluru.		
Description of the area with clear demarcation of boundaries or with GPS readings	Sl.	Latitude N	Longitude E
	1	7827774.985	1434743.232
	Rashtriya Military School Metro Station Project Area		
Enumeration of trees <ul style="list-style-type: none">Total no. of trees standing in the project areaTotal no. of trees proposed to be removed	01 No (Annexure-1)	Description of trees, species, location, area, etc., are uploaded in the website of BBMP for information of all. (www.bbmp.gov.in)	
	01 No (Annexure-1)		
Mode of communication of comments (Public can send their comments either by E-mail / Post / Hand)	Address: The Deputy Conservator of Forests & Tree Officer, BBMP, N.R Square, Bangalore- 560002. E-mail id: 1. dcfbbmp12@gmail.com for Tree Officer, BBMP 2. shivayogi@bmrc.co.in for Dy CE, BMRCL * Comments communicated directly to BMRCL, should also be marked to the Tree-Officer/DCF, BBMP		
Deadline for filing objections	Ten (10) days from the date of publication of this notification in the Newspaper * Objections/Comments/Suggestions should be relevant and specific to the project		

In view of the above, the suggestions/objections/comments are invited from citizens under Section 8 (3) (vii) of the Karnataka Preservation of Tree Act, 1976.

Tree Officer

Deputy Conservator of Forests,
BBMP, Bengaluru



ಬೃಹತ್ ಬೆಂಗಳೂರು ಮಹಾನಗರ ಪಾಲಿಕೆ

ಉಪ ಅರಣ್ಯ ಸಂರಕ್ಷಣಾಧಿಕಾರಿಗಳು, ಅರಣ್ಯ ಘಟಕ,
ಬೃಹತ್ ಬೆಂಗಳೂರು ಮಹಾನಗರ ಪಾಲಿಕೆ

ಅನೆಕ್ಸ್ ಜಿಲ್ಲಾಂಗ್ - 3, ಎನ್. ಆರ್. ವೃತ್ತ, ಬೆಂಗಳೂರು-560 002

ಸಂಖ್ಯೆ: ಉಸಂ/ಪಿಆರ್/ 330 /2023-24

ದಿನಾಂಕ: 16.06.2023

ಸಾರ್ವಜನಿಕ ಪ್ರಕಟಣೆ

ಈ ಮೂಲಕ ಬೆಂಗಳೂರು ಮಹಾನಗರ ಮತ್ತು ಸುತ್ತಮುತ್ತಲಿನ ಸಮಸ್ತ ನಾಗಕರೀಕರ ಗಮನಕ್ಕೆ ತರಬಯಿಸುತ್ತಿರುವುದೇನೆಂದರೆ, ಉಪಮುಖ್ಯ ಅಭಿಯಂತರರು, ರೀಜ್ 6, ನೆಲಮಾಳಿಗೆ, ಬೆಂಗಳೂರು ಮೆಟ್ರೋ ರೈಲು ನಿಗಮ ನಿಯಮಿತ, ಬೆಂಗಳೂರು ಇವರು ರಾಷ್ಟ್ರೀಯ ಮಿಲಿಟರಿ ಶಾಲೆ ಮೆಟ್ರೋ ನಿಲ್ದಾಣದ ಆವರಣದಲ್ಲಿ ಇರುವ ಮರದ ತೆರವಿಗಾಗಿ ಮನವಿ ಸಲ್ಲಿಸಿರುವ ವಿವರಗಳು ಈ ಕೆಳಕಂಡಂತಿರುತ್ತವೆ:

ಯೋಜನೆಯ ಹೆಸರು	Construction of Elevated Rashtriya Military School Metro Station in Reach 6, Under Ground Line		
ಎಜೆನ್ಸಿಯ ಹೆಸರು	ಬೆಂಗಳೂರು ಮೆಟ್ರೋ ರೈಲು ನಿಗಮ ನಿಯಮಿತ, ಬೆಂಗಳೂರು		
ಮರ ತೆರವುಗೊಳಿಸುವ ಉದ್ದೇಶ	ರಾಷ್ಟ್ರೀಯ ಮಿಲಿಟರಿ ಶಾಲೆ, ರೀಜ್ 6, ನೆಲಮಾಳಿಗೆ ಕಾಮಗಾರಿಗೆ ಅಡ್ಡ ಬರುತ್ತಿರುವ ಮರದ ತೆರವಿಗಾಗಿ.		
ಯೋಜನಾ ಪ್ರದೇಶದ ನಿರ್ದೇಶಾಂಕಗಳು	Sl.	Latitude N	Longitude E
	1	7827774.985	1434743.232
ಯೋಜನಾ ಪ್ರದೇಶದಲ್ಲಿ ಪ್ರಸ್ತುತ ಇರುವ ಮರಗಳು	01 No (Annexure-1)	ಮರಗಳ ಜಾತಿ, ಅಳತೆಪಟ್ಟಿ ಹಾಗೂ ಮರಗಳಿರುವ ಜಾಗಗಳ ವಿವರಗಳನ್ನು ಬಿಬಿಎಂಪಿ ವೆಬ್ ಸೈಟ್ ನಲ್ಲಿ ಮಾಹಿತಿಗಾಗಿ ಒದಗಿಸಲಾಗಿದೆ. (www.bbmp.gov.in)	
ಯೋಜನಾ ಪ್ರದೇಶದಲ್ಲಿ ತೆರವುಗೊಳಿಸಬೇಕಾದ ಮರಗಳು	01 No (Annexure-1)		
ಆಕ್ಷೇಪಣೆಗಳನ್ನು ಸಲ್ಲಿಸುವ ವಿಧಾನ (ಸಾರ್ವಜನಿಕರು ನೇರವಾಗಿ/ಇ-ಮೇಲ್/ಅಂಚೆ ಮುಖಾಂತರ ಈ ಕೆಳ ಸಹಿದಾರರ ಕಛೇರಿಗೆ ಸಲ್ಲಿಸಬಹುದು)	ವಿಳಾಸ: ಉಪ ಅರಣ್ಯ ಸಂರಕ್ಷಣಾಧಿಕಾರಿ, ಬಿಬಿಎಂಪಿ, ಎನ್.ಆರ್. ಸ್ವೇರ್, ಬೆಂಗಳೂರು - 560 002. Email ID: 1. dcfbbmp12@gmail.com for Tree Officer, BBMP 2. shivayogi@bmrc.co.in for Dy CE, BMRCL * ಆಕ್ಷೇಪಣೆಗಳನ್ನು BMRCLಗೆ ಸಲ್ಲಿಸಿದ್ದಲ್ಲಿ, ಅದರ ಪ್ರತಿಯನ್ನು DCF, BBMP ರವರಿಗೂ ಸಲ್ಲಿಸತಕ್ಕದ್ದು		
ಆಕ್ಷೇಪಣೆಗಳನ್ನು ಸಲ್ಲಿಸಬೇಕಾದ ಅವಧಿ	ಈ ಪ್ರಕಟಣೆ ಹೊರಡಿಸಿದ ದಿನಾಂಕದಿಂದ 10 ದಿನಗಳೊಳಗಾಗಿ ಸಲ್ಲಿಸತಕ್ಕದ್ದು. ಸೂಚನೆ: ಆಕ್ಷೇಪಣೆಗಳು ಪ್ರಸ್ತಾವಿತ ಯೋಜನೆಗೆ ಮಾತ್ರ ಸಂಬಂಧಿಸಿರಬೇಕು.		

ಮೇಲ್ಕಂಡ ಪ್ರದೇಶದಲ್ಲಿನ ಮರಗಳನ್ನು ತೆರವುಗೊಳಿಸುವ ಸಂಬಂಧ ಸಾರ್ವಜನಿಕರ ಆಕ್ಷೇಪಣೆ/ಸಲಹೆಗಳಿದ್ದಲ್ಲಿ ಕರ್ನಾಟಕ ವೃಕ್ಷ ಸಂರಕ್ಷಣಾ ಕಾಯಿದೆ 1976 ಸೆಕ್ಷನ್ 8 (3) (vii) ಪ್ರಕಾರ ಸಲಹೆ - ಸೂಚನೆಗಳನ್ನು ನೀಡಲು ಆಹ್ವಾನಿಸಲಾಗಿದೆ.

ವೃಕ್ಷ ಅಧಿಕಾರಿ,

ಉಪ ಅರಣ್ಯ ಸಂರಕ್ಷಣಾಧಿಕಾರಿ
ಬಿಬಿಎಂಪಿ, ಬೆಂಗಳೂರು

FORM I

KARNATAKA PRESERVATION OF TREES RULES, 1977

FORM NO.I

[See Rule 4(1)]

Form of Application

From,
The Chief Engineer,
Reach-6, UG,
Bangalore Metro Rail Corporation
BMTC Complex III rd floor
KH Road, Bangalore-560027

Date: 29.04.2023

To,
The Deputy Conservator of Forest (Tree Officer),
BBMP, N.R.Square,
City Corporation, Bengaluru-560003

Sir,

BMRCL intend to clear the trees infringing the R6 Underground Metro construction works. The details of the infringing tree is enclosed for your further necessary action.

1.	Sy. No. and extent of the land from which the trees are to be felled.	Rashtriya Military School Station
2.	Location of the Sy. No. with Sy. Sketch.	Enclosed as Annexure II
3.	Whether the boundary of Sy. No. is clear and demarcated properly on the ground	YES
4.	Enumeration of Trees (a) Total number of trees standing in the project area (b) Total number of trees proposed to be removed(Felling/Translocation)	1 (Annexure I) 1 (Annexure I)
5.	The purpose for which the trees are to be felled (specific mention to be made about the purpose)	Infringing the station ancillary building
6.	Khata extract and Certificate from the Tahasildar regarding the tenure of the Land (Hiduvali, Darkhast, Inam, Lease, Coffee/ Cardamum, Malki, Bane and so on and whether the tree growth is redeemed or unredeemed) and the right over the Land and Tree growth.	NA
7.	Whether any tree proposed to be felled is reserved to Government, if so, details may be given.	NA
8.	Whether unconditional consent of the other owners having share in the right to land and the trees if any is obtained (proof thereof to be enclosed).	NA



DRP
Chidamand
For necessary
action

AP KRB

FORM I

KARNATAKA PRESERVATION OF TREES RULES, 1977

9.	Whether the licensee or certificate in respect of the following is enclosed in case the purpose of felling is for; (i) Coffee cultivation – Certificate from Coffee Board. (ii) Rubber Cultivation – Certificate from Rubber Board. (iii) Cardamom Cultivation Certificate from Cardamom Board. (iv) For construction of building Certificate from Village Panchayat or Executive Officers of the Municipality as the case may be.	NA

We therefore, request you to accord permission for clearance of tree infringing the Bangalore Metro Construction works.

We are prepared to furnish other particulars if any require and demanded by the tree officer in this regard during the course of enquiry.

We agree to abide by the provision of the Karnataka Preservation of Trees Act, 1976 and the Karnataka Forest Act, 1963 and the rules made there under and such other conditions that may be imposed by the Tree officer.

We do hereby agree to indemnify Government of Karnataka against any loss or damage caused on account of permission accorded to me by the Tree Officer based on erroneous or wrong information furnished by me.

Yours faithfully,

ff
Rath Shivayagi SK
29/04/23
Chief Engineer
Reach-06 (UG), BMRCL.
(Applicant)

200 800/2000

Annexure-I

SL.No	Tree Number	Species	Girth (mts)	Height(mts)	Lattitude	Longitude	Remarks
1	1	Mango	1.05	2.5	7827774.985	1434743.232	Exempted as per tree act

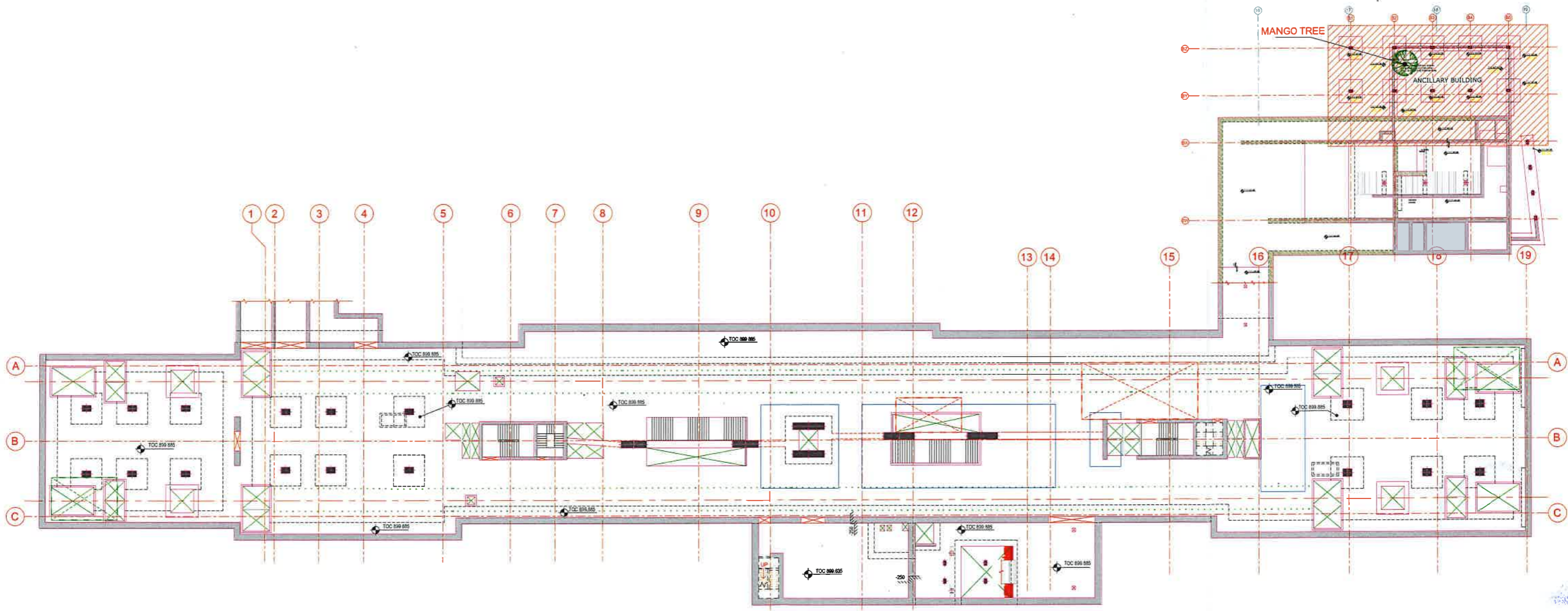

Rash
Praveen

CLIENT	ಬೆಂಗಳೂರು ಮೆಟ್ರೋ ರೈಲ್ ನಿಗಮ ನಿಯಮಿತ BANGALORE METRO RAIL CORPORATION LTD
DRAWING TITLE	RASHTRIYA MILITARY SCHOOL (VELLARA) HINDRANCE AT ANCILLARY BUILDING DUE TO TREE

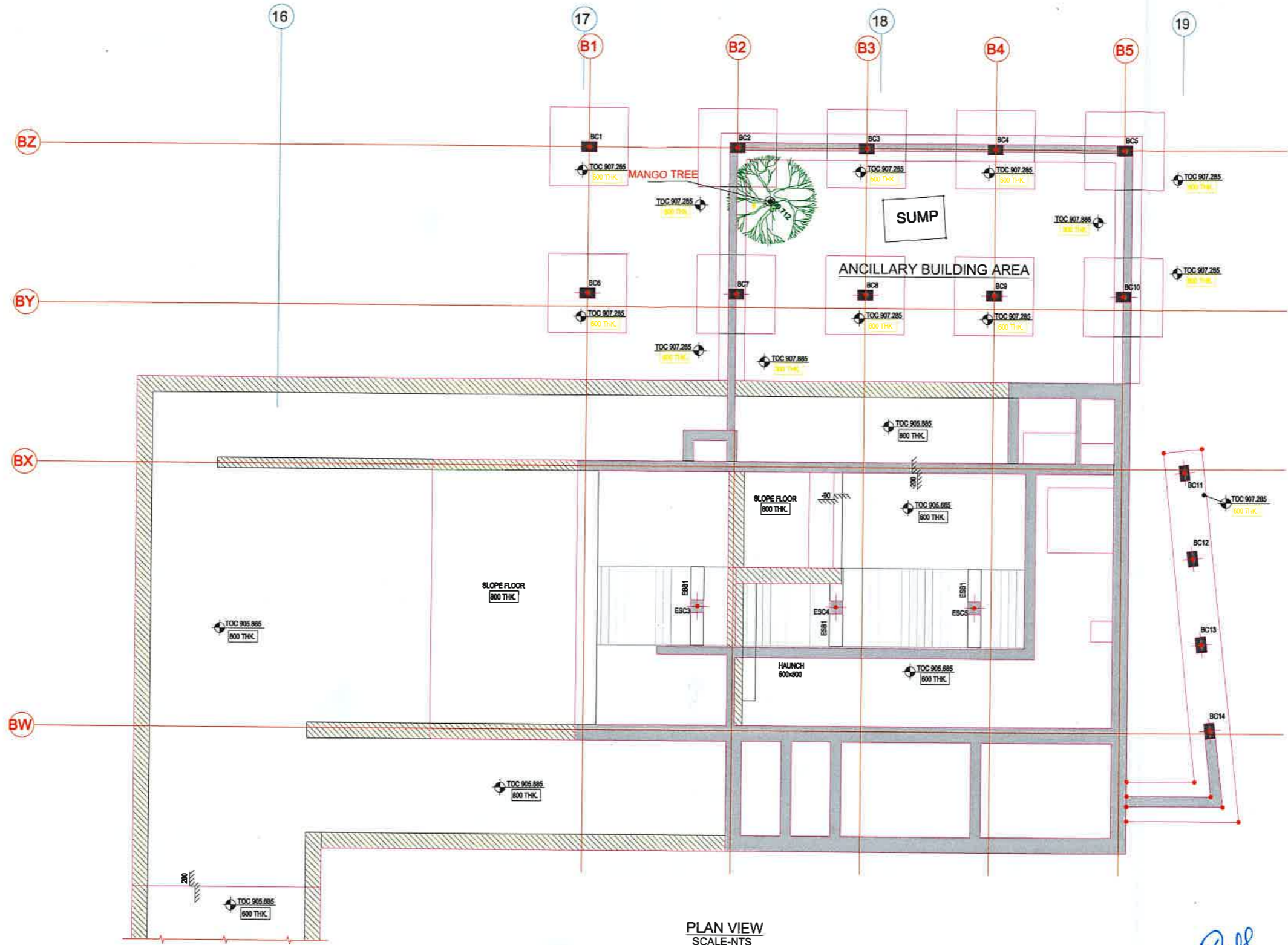

PLAN VIEW
SCALE-NTS

Rash
24/07/2018

CLIENT	ಬೆಂಗಳೂರು ಮೆಟ್ರೋ ರೈಲ್ ನಿಗಮ ನಿಯಮಿತ BANGALORE METRO RAIL CORPORATION LTD
DRAWING TITLE	RASHTRIYA MILITARY SCHOOL (VELLARA) HINDRANCE AT ANCILLARY BUILDING DUE TO TREE